

NOTICE DE
MONTAGE
 ASSEMBLY
INSTRUCTIONS
 MONTAGEANLEITUNG
 INSTRUCCIONES
DE MONTAJE
 MONTAGEVOORSCHRIFT
 ISTRUZIONI DI
MONTAGGIO
 INSTRUÇÕES
DE MONTAGEM
 INSTRUKCJA
MONTAŻU
 NAPUTCI ZA
MONTAŽU

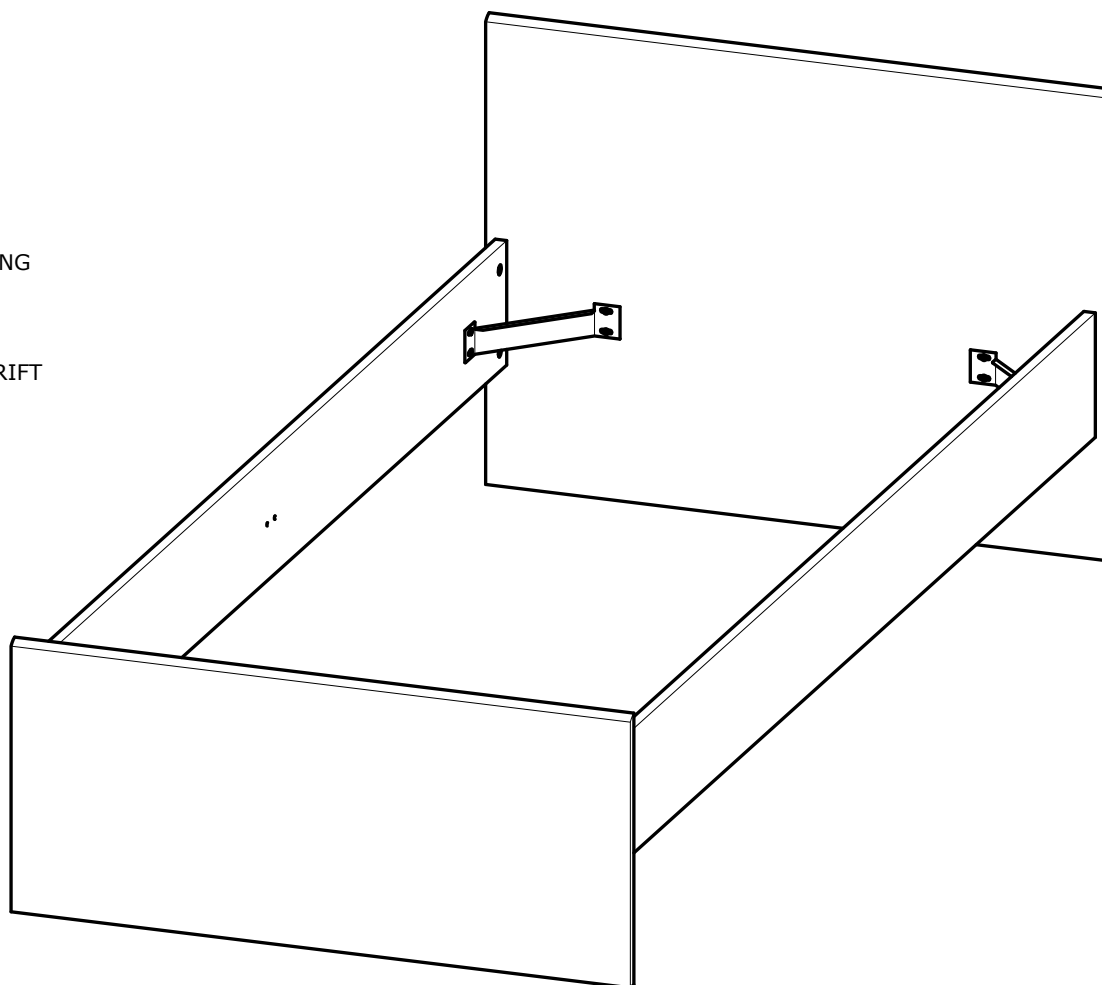

Francais:

Notice a conserver.

En cours de montage, prenez garde aux risques de pincement et de cisaillement.

Ne pas mettre le lit a proximite d'une source de chaleur.

Ne pas s'asseoir a plusieurs sur le lit.

Ne pas sauter sur le lit.

Stocker le lit dans un endroit sec.

English:

Retain the instructions for future reference.

During the assembly, beware the risks of pinching and shearing.

Keep the product away from heat sources.

Do not sit on the bed several.

Do not jump on the bed.

Store the bed in a dry place.

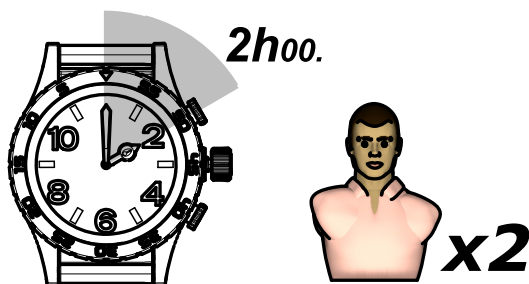

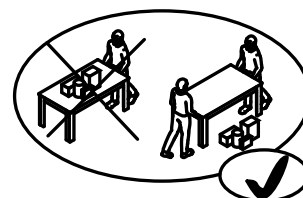
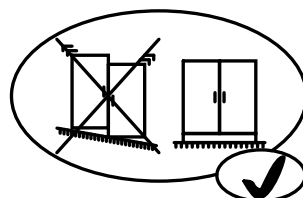
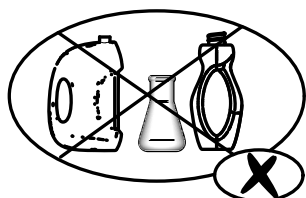
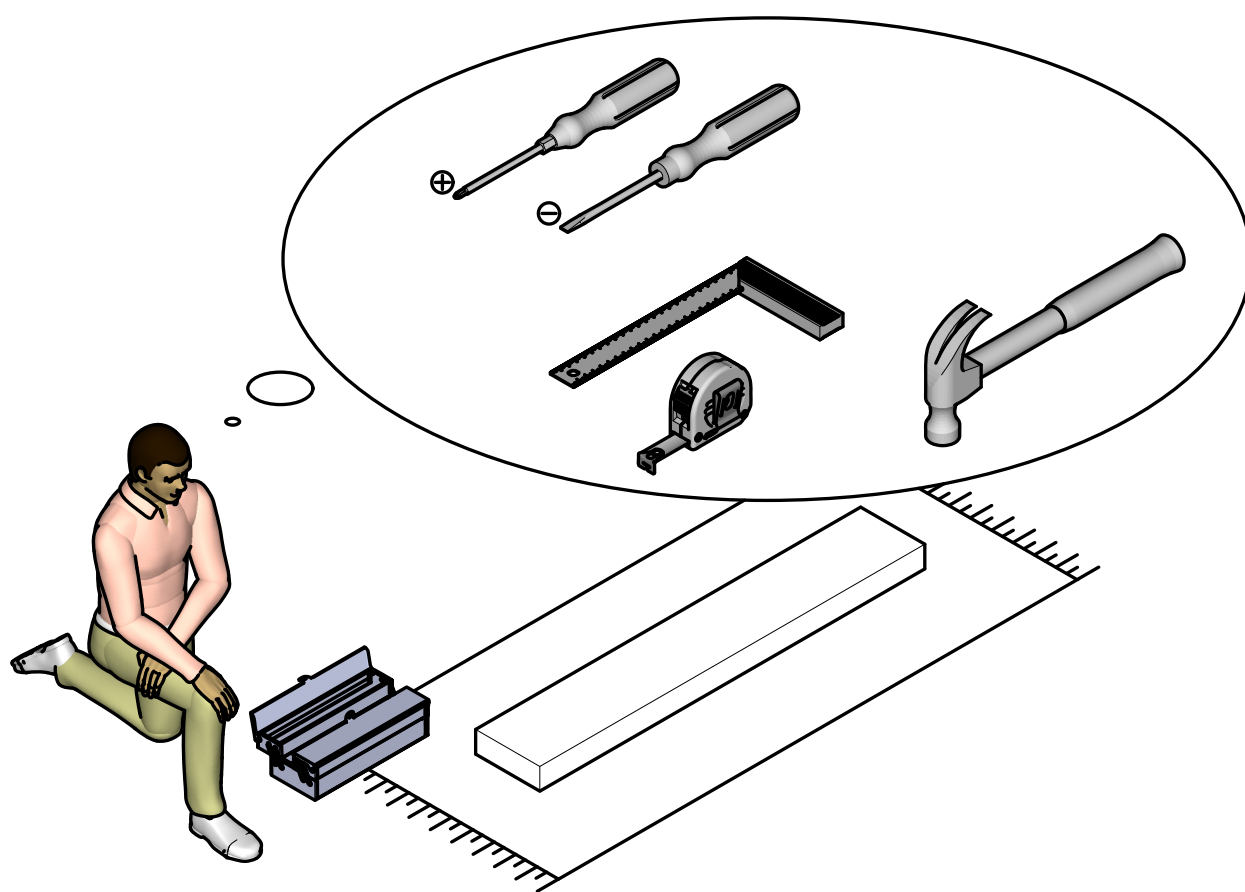
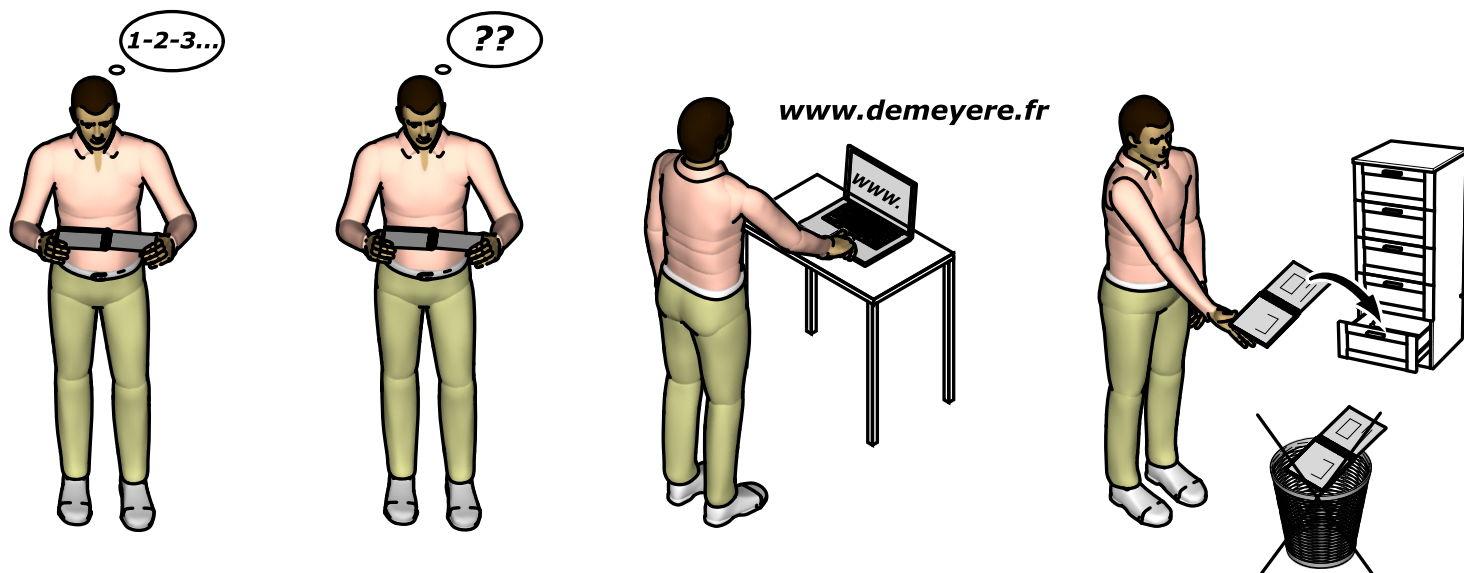



A x8

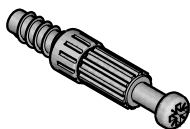

B x8



C x4



D x8

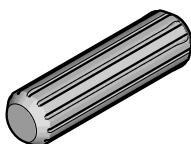

E x16



TR 6,3x13mm

F x4

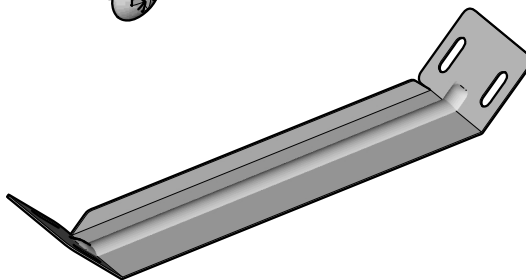

0 1 2 3 4 5 6 7 8 9 10cm

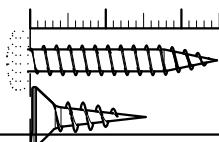

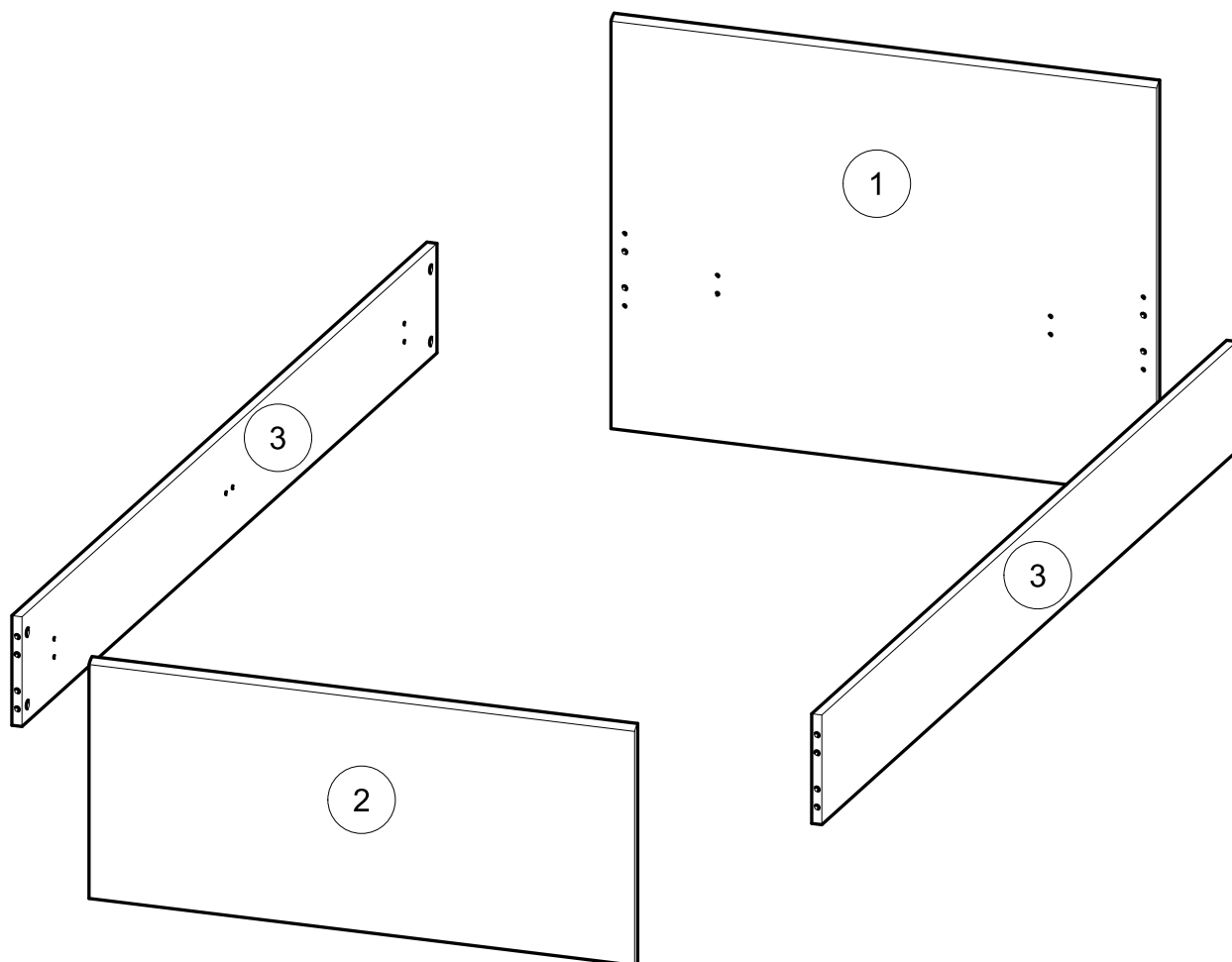

N°	Dim. (mm)		Qty.
1	970 x	730	x1
2	970 x	423	x1
3	1 998 x	194	x2

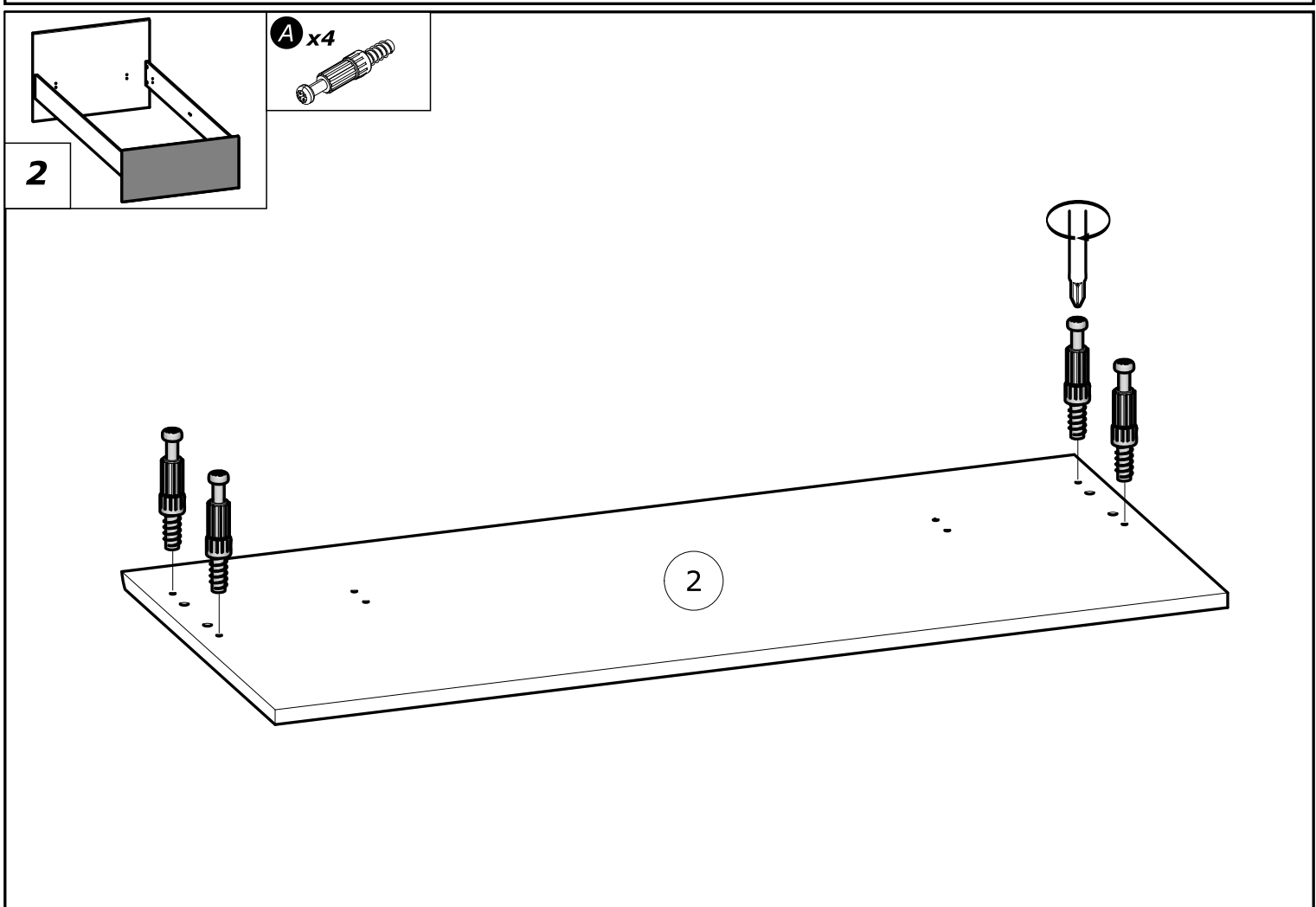
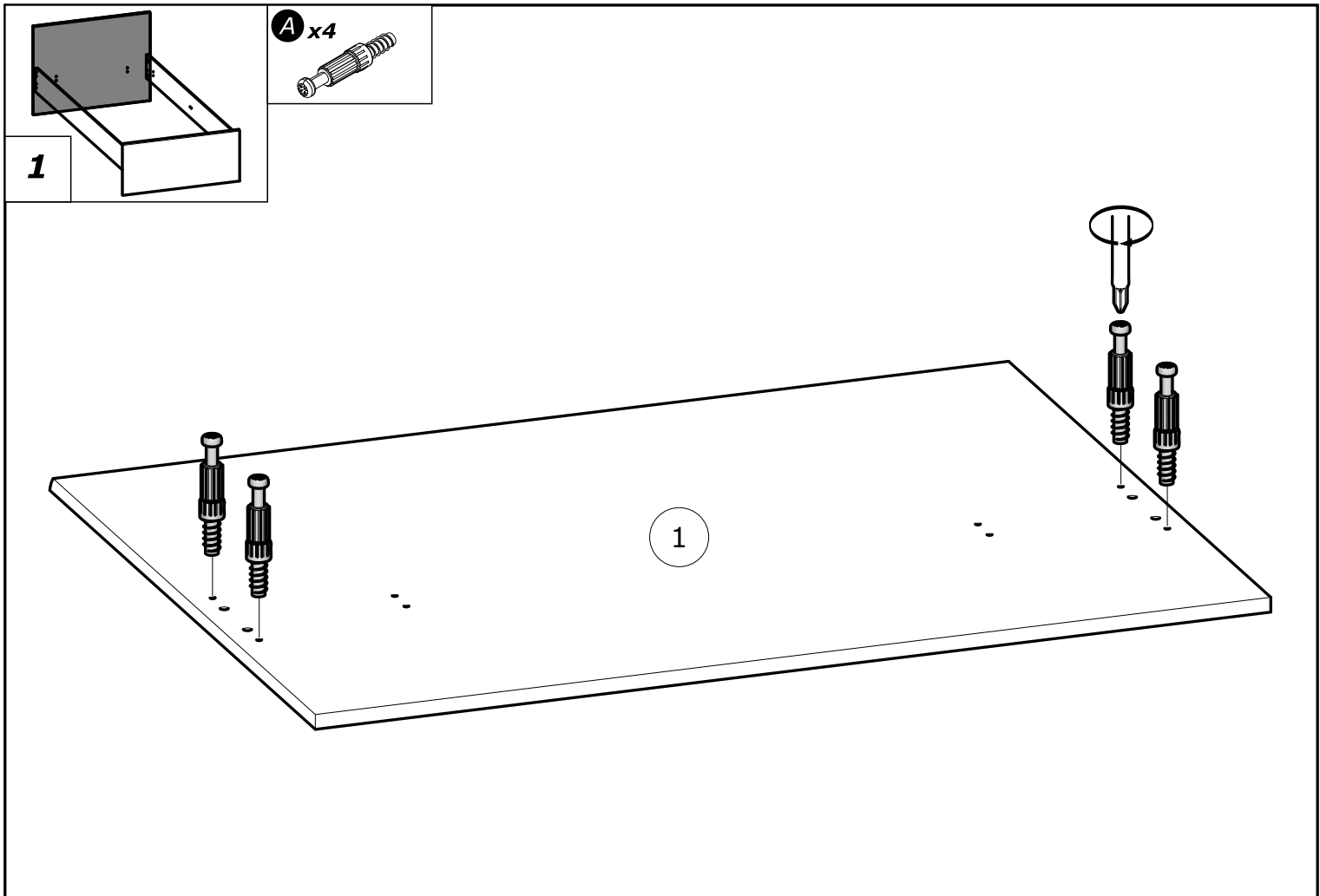

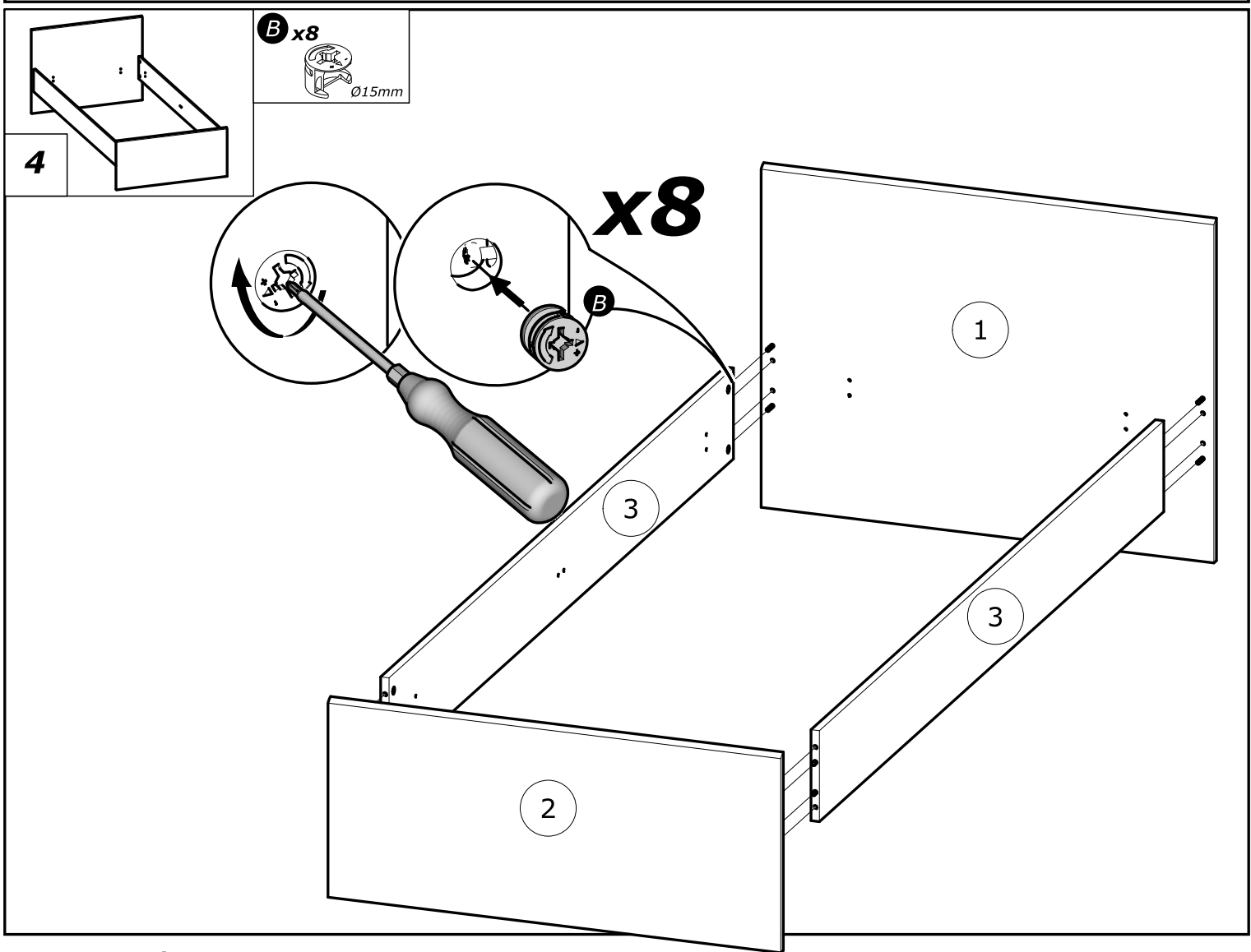
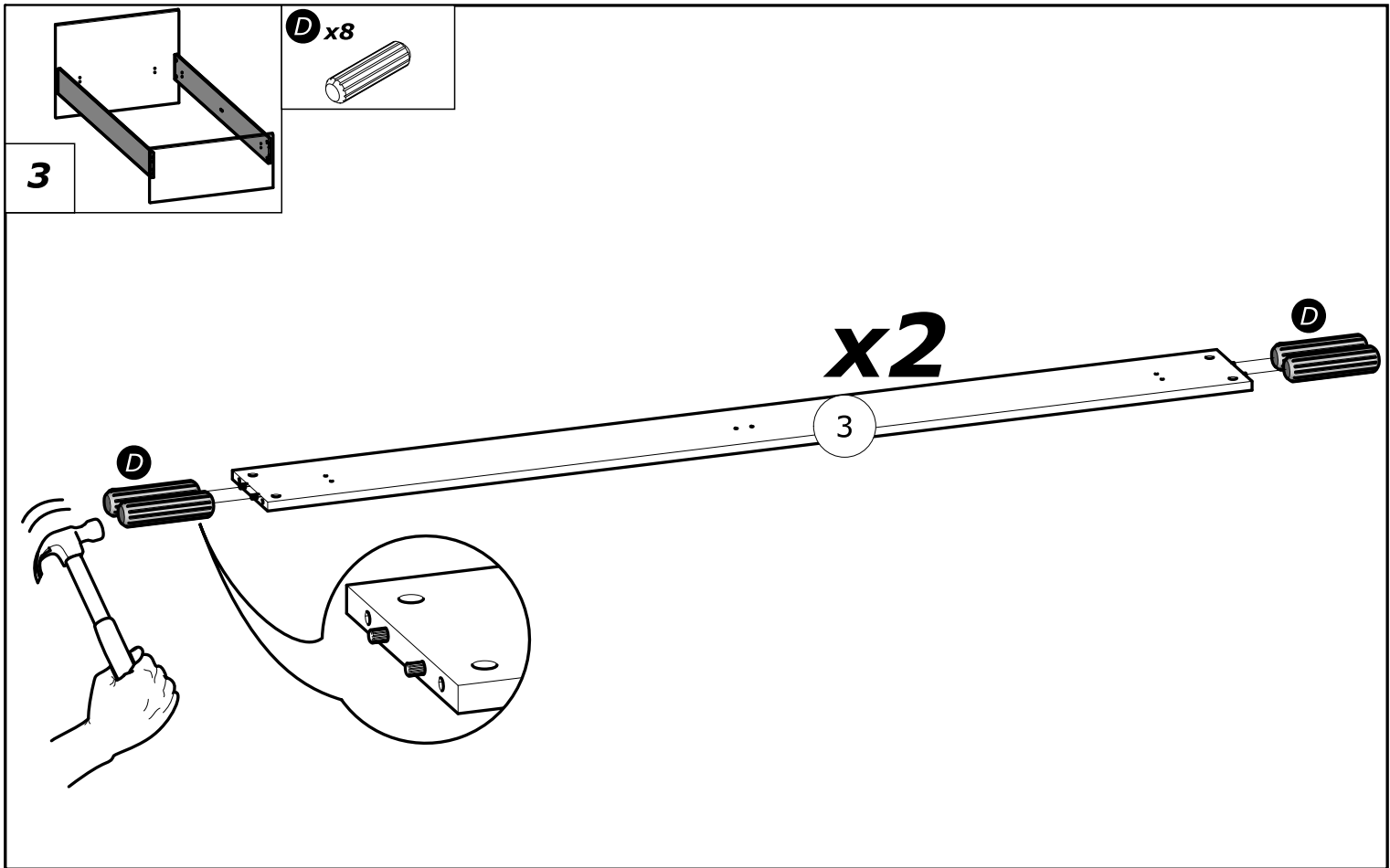

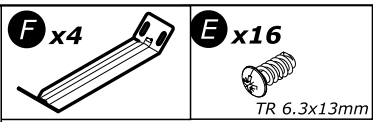
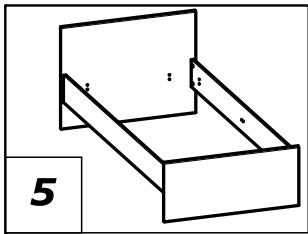

x4

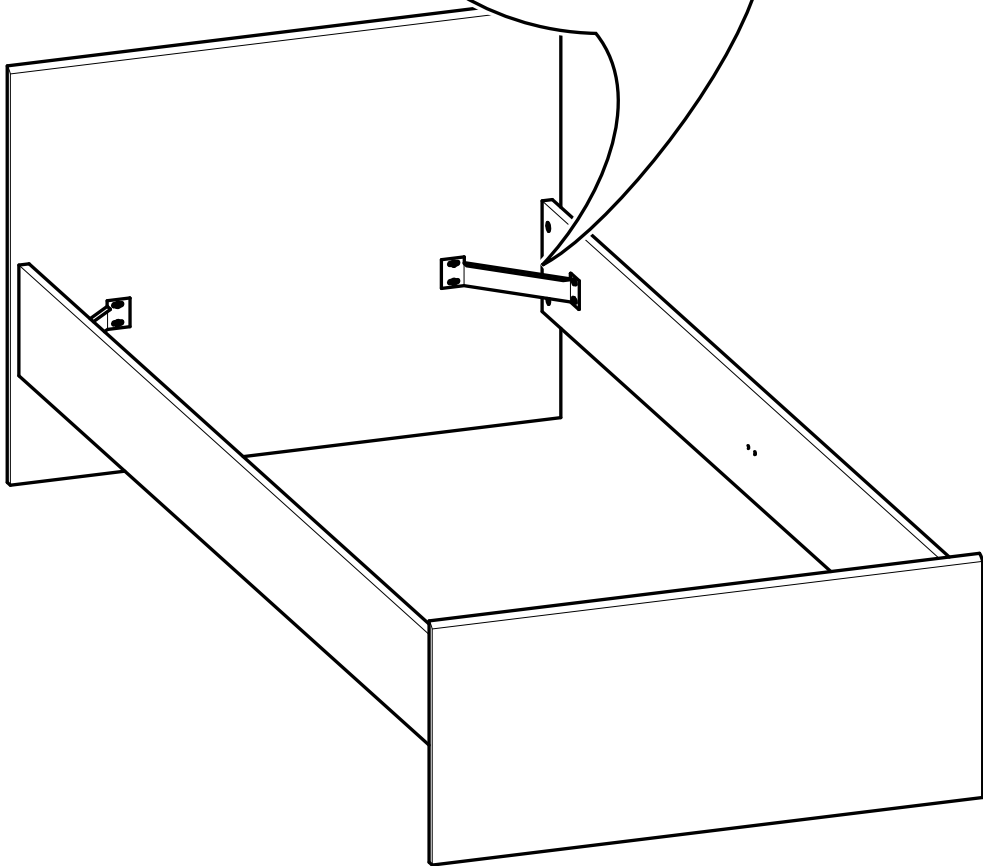
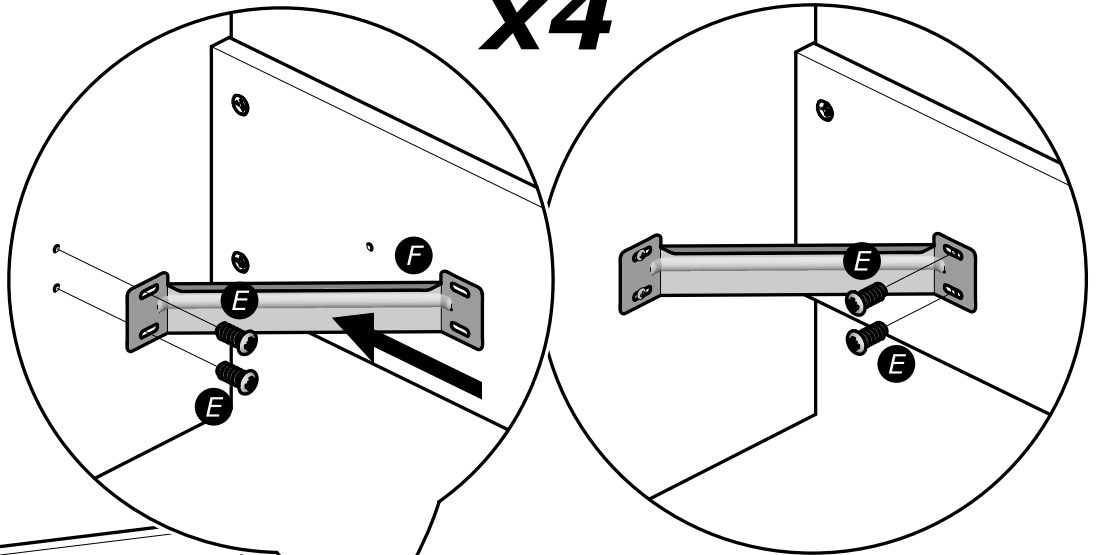

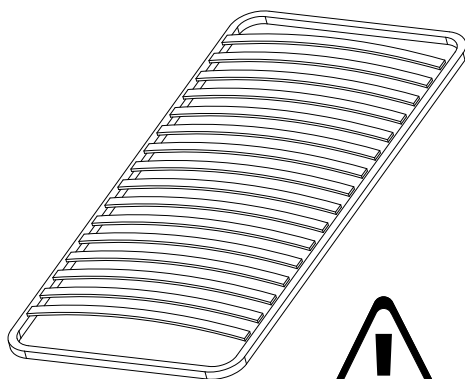
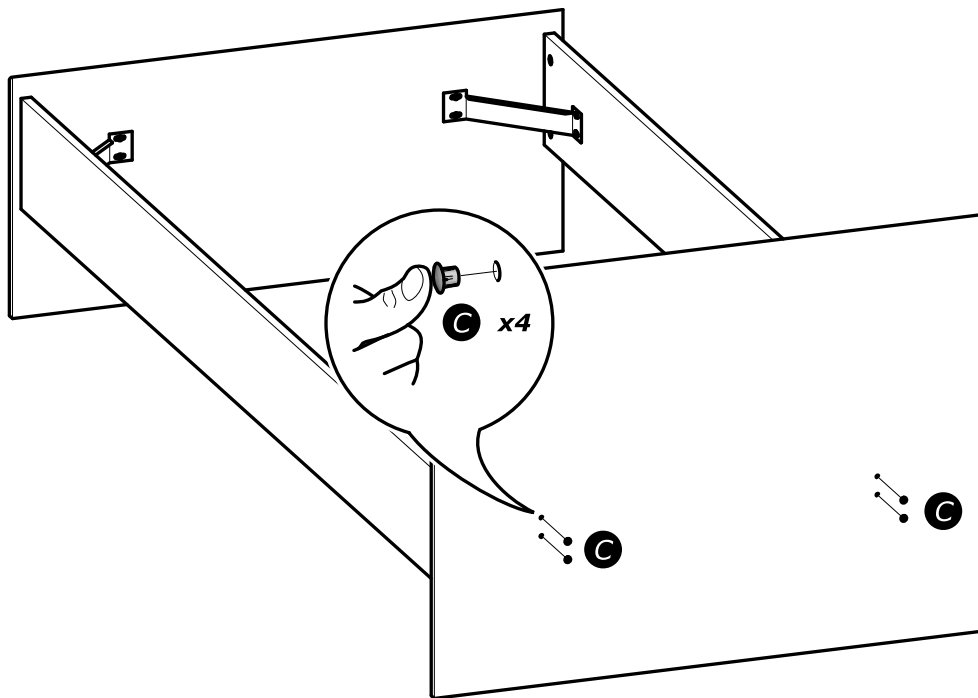
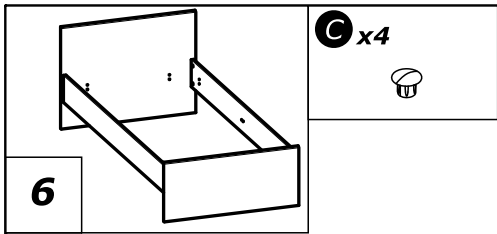

**Dimensions du sommier
cadre métallique à lattes**

**The metal frame Slatted
bed base dimensions**



**NON INCLUS
NOT SUPPLIED**

90x200 cm



Info tri déchets

www.quefairedemesdechets.fr